

GOVERNOR

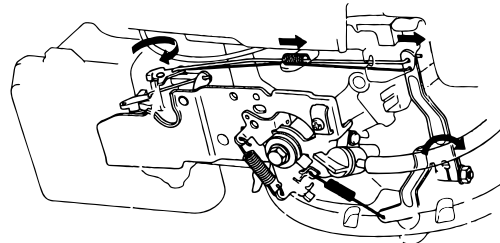

	Maximum speed (no load)
European model, with fly-wheel brake	3,000 \pm 10 min ⁻¹ (rpm)
Except for European model, with flywheel brake	3,100 \pm 150 min ⁻¹ (rpm)
Except for European model, without flywheel brake	

VALVE CLEARANCE

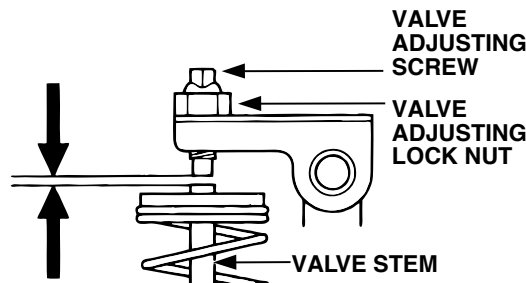

To increase valve clearance, screw out.
To decrease valve clearance, screw in.

Standard valve clearance	IN	EX	0.15 \pm 0.04 mm (0.006 \pm 0.002 in)
			0.20 \pm 0.04 mm (0.008 \pm 0.002 in)

IGNITION COIL AIR GAP

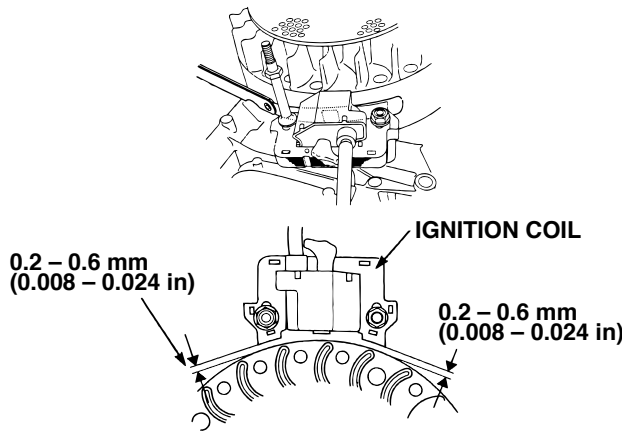

Specified clearance	0.2 - 0.6 mm (0.008 - 0.024 in)
---------------------	---------------------------------

Gasoline is highly flammable and explosive.
Check to see whether the fuel is not leaking
from the fuel system parts.

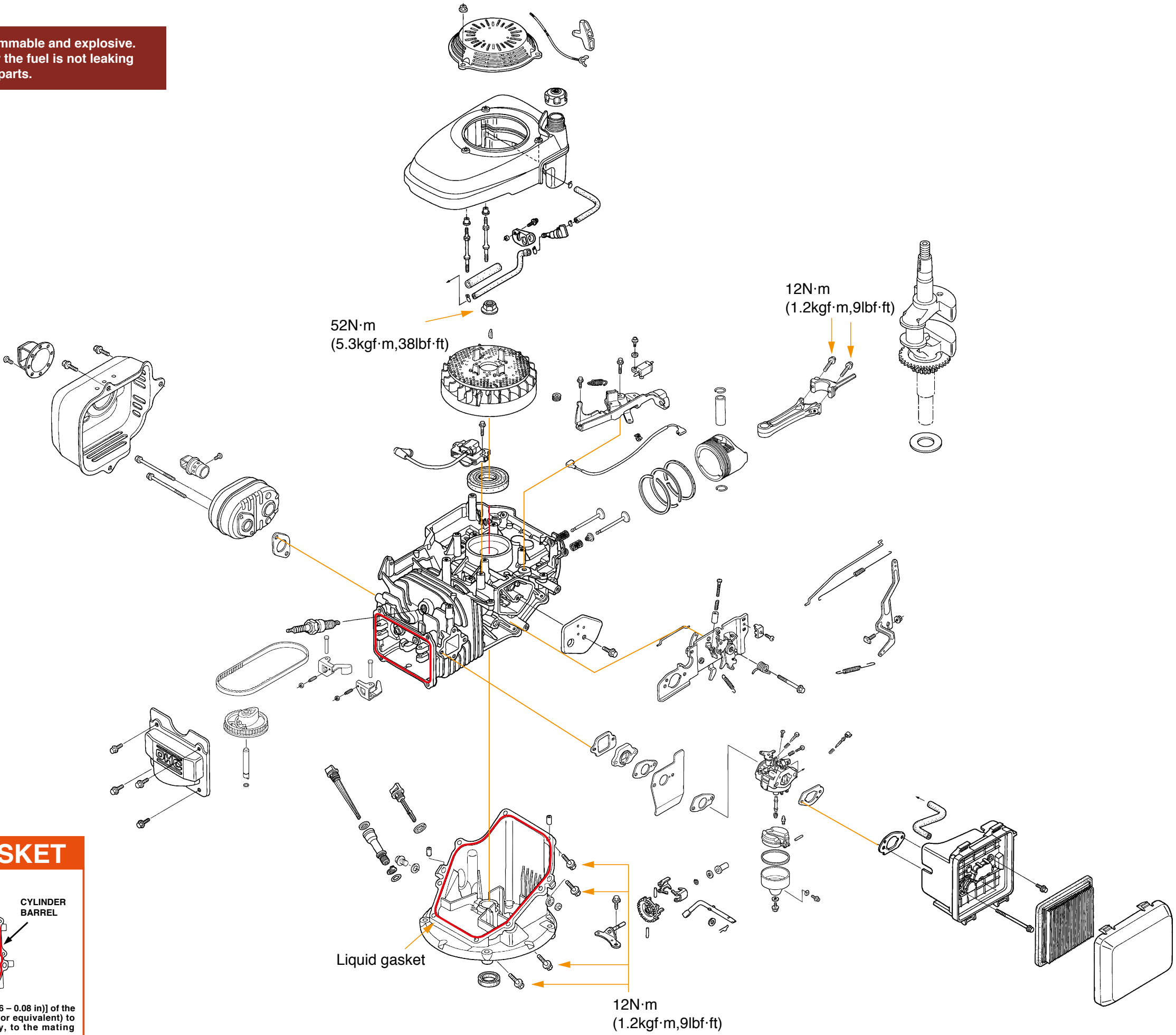

LIQUID GASKET

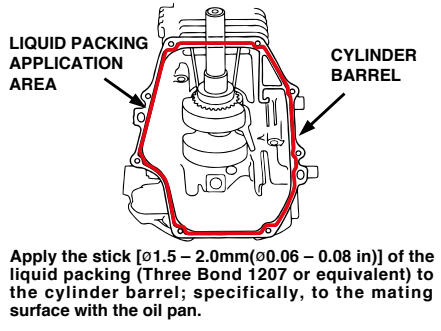

Apply the stick [0.15 - 2.0mm (0.06 - 0.08 in)] of the liquid packing (Three Bond 1207 or equivalent) to the cylinder barrel; specifically, to the mating surface with the oil pan.

© Honda Motor Co., Ltd. Power Product Service Division.

ENGINE OIL

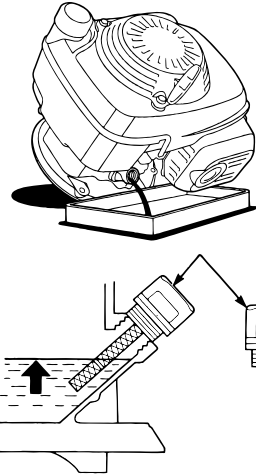

Engine oil capacity	0.55L (0.58 US qt, 0.48 Imp qt)
Recommended operating ambient temperature	-5°C - 40°C (23°F - 104°F)

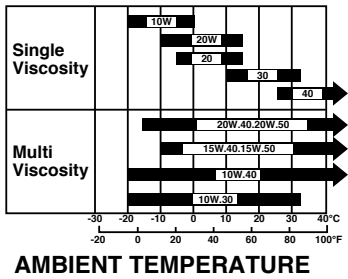

AIR CLEANER

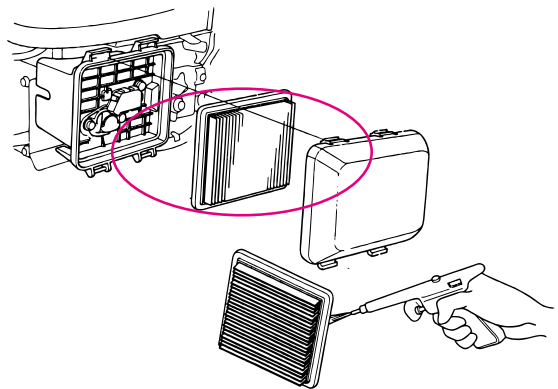

Wipe dirt from the inside of the air cleaner cover and air cleaner case, using a moist rag. Be careful to prevent dirt from entering the air duct that leads to the carburetor.

SPARK PLUG

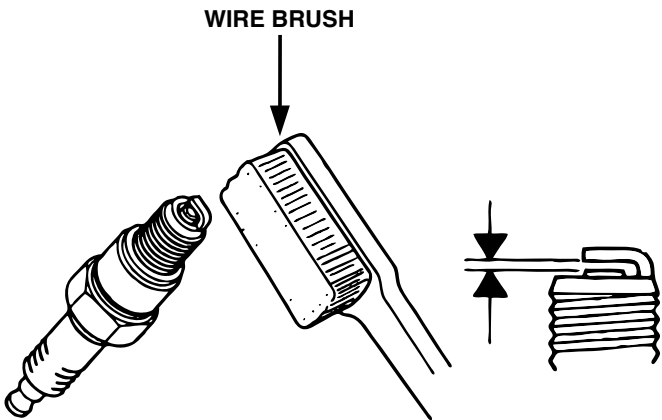

Spark plug gap	0.7 - 0.8 mm (0.028 - 0.031 in)
----------------	---------------------------------

PISTON DISASSEMBLY/REASSEMBLY

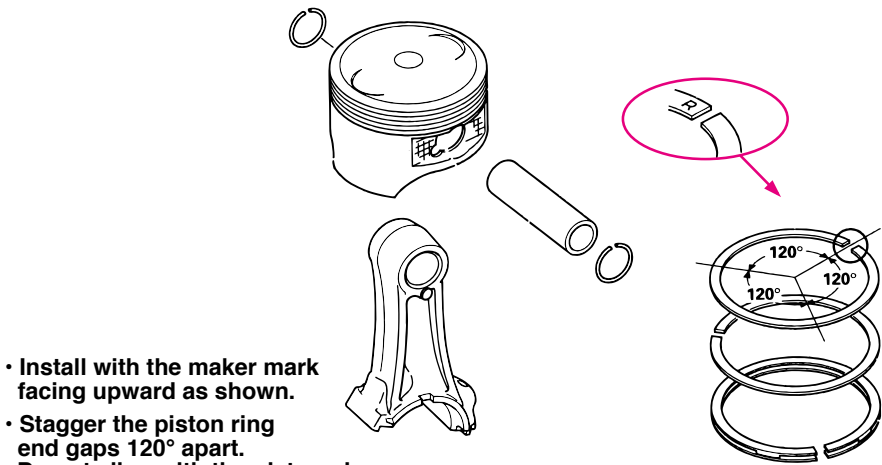

- Install with the maker mark facing upward as shown.
- Stagger the piston ring end gaps 120° apart. Do not align with the piston pin.

PISTON ASSEMBLY

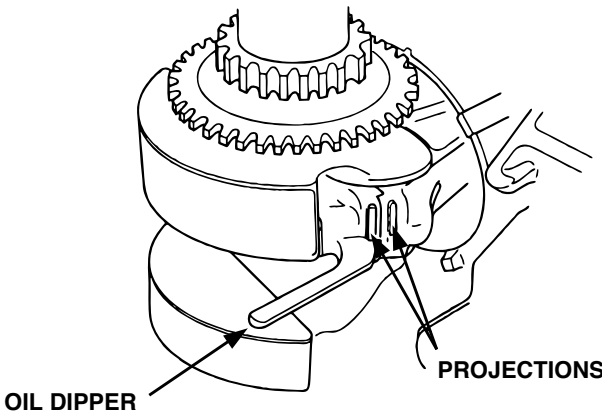

CARBURETOR DISASSEMBLY/REASSEMBLY

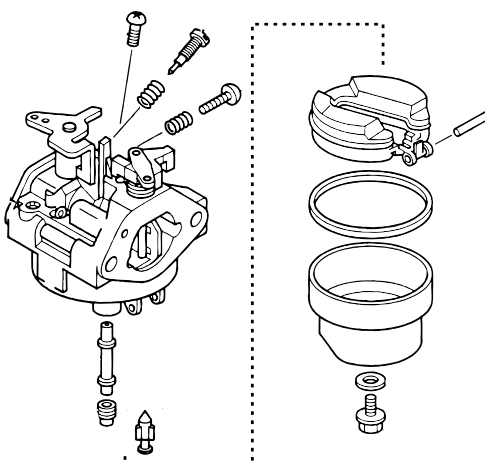

CARBURETOR REMOVAL/INSTALLATION

