

GOVERNOR

ADJUSTMENT

Loosen the nut (6 mm) (1) of the governor arm nut (6 mm). Turn the governor arm (2) clockwise to fully open the carburetor throttle valve (3).

Rotate the governor arm shaft (4) as far as it will go in the same direction the governor arm moved to open the throttle valve.

Make sure the carburetor throttle valve is fully open. Tighten the nut (6 mm) securely.

MAXIMUM SPEED ADJUSTMENT

Use a tachometer with graduations of 50 min⁻¹ (rpm) or smaller that will accurately indicate 50 min⁻¹ (rpm) changes. Start the engine and allow it to warm up to normal operating temperature. Move the control lever (5) to run the engine at the specified maximum speed, and hold the control lever. Make sure the carburetor throttle valve (3) is fully open. Turn the screw (6) of the control base to obtain the specified maximum speed.

MAXIMUM SPEED	
GP160H:	3,900 ± 100 min ⁻¹ (rpm)
GP200H:	3,850 ± 150 min ⁻¹ (rpm)

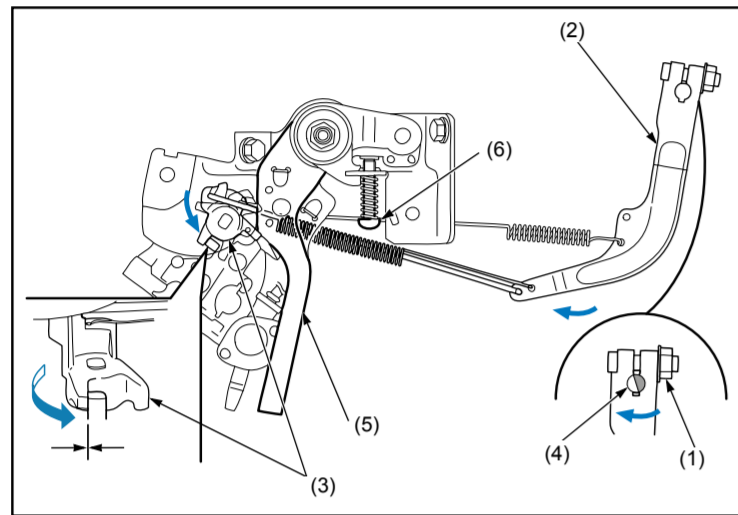

VALVE CLEARANCE

ADJUSTMENT

Hold the rocker arm pivot (1) and loosen the pivot lock nut (2). Insert a feeler gauge (3) between the valve rocker arm and the valve stem. Adjust by turning the rocker arm pivot until there is a slight drag on the feeler gauge.

Hold the rocker arm pivot and retighten the pivot lock nut to the specified torque.

VALVE CLEARANCE	
IN	0.15 ± 0.02 mm
EX	0.20 ± 0.02 mm

Recheck the valve clearance, and if necessary, readjust the clearance.

Replace the head cover packing with a new one and install the removed parts in the reverse order of removal.

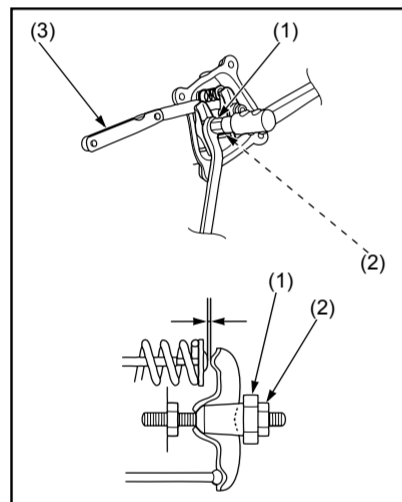

IGNITION COIL

IGNITION COIL AIR GAP

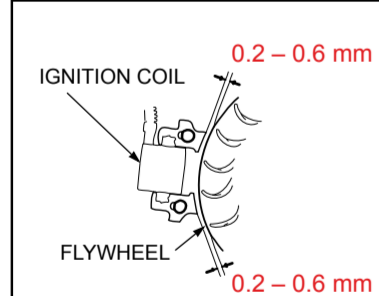

INSPECTION

PRIMARY SIDE

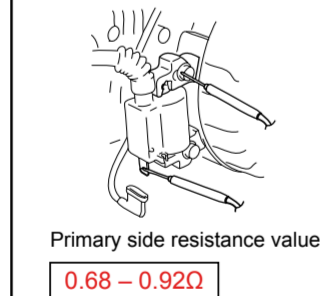

SECONDARY SIDE

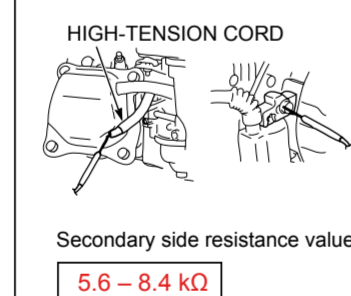

PISTON DISASSEMBLY/REASSEMBLY

PISTON

Install all rings with the markings facing up. Space the piston ring end gaps 120° apart.

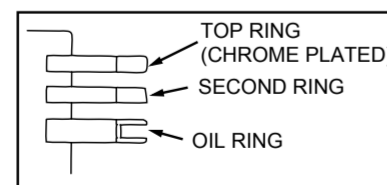
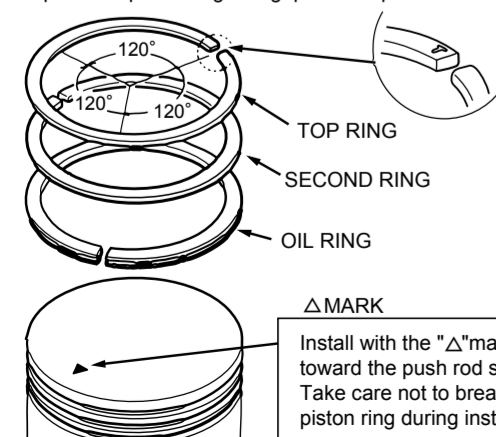

CONNECTING ROD

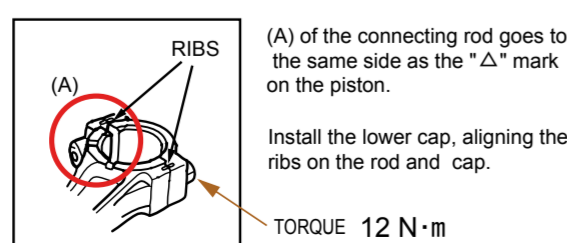

Gasoline is highly flammable and explosive. Check to see whether the fuel is not leaking from the fuel system parts.

LIQUID GASKET CRANKCASE COVER

ThreeBond 1216E or equivalent
 • Assemble within 10 minutes after applying the liquid gasket.
 • Wait for 30 minutes after assembly. Do not add oil or start the engine during this period.

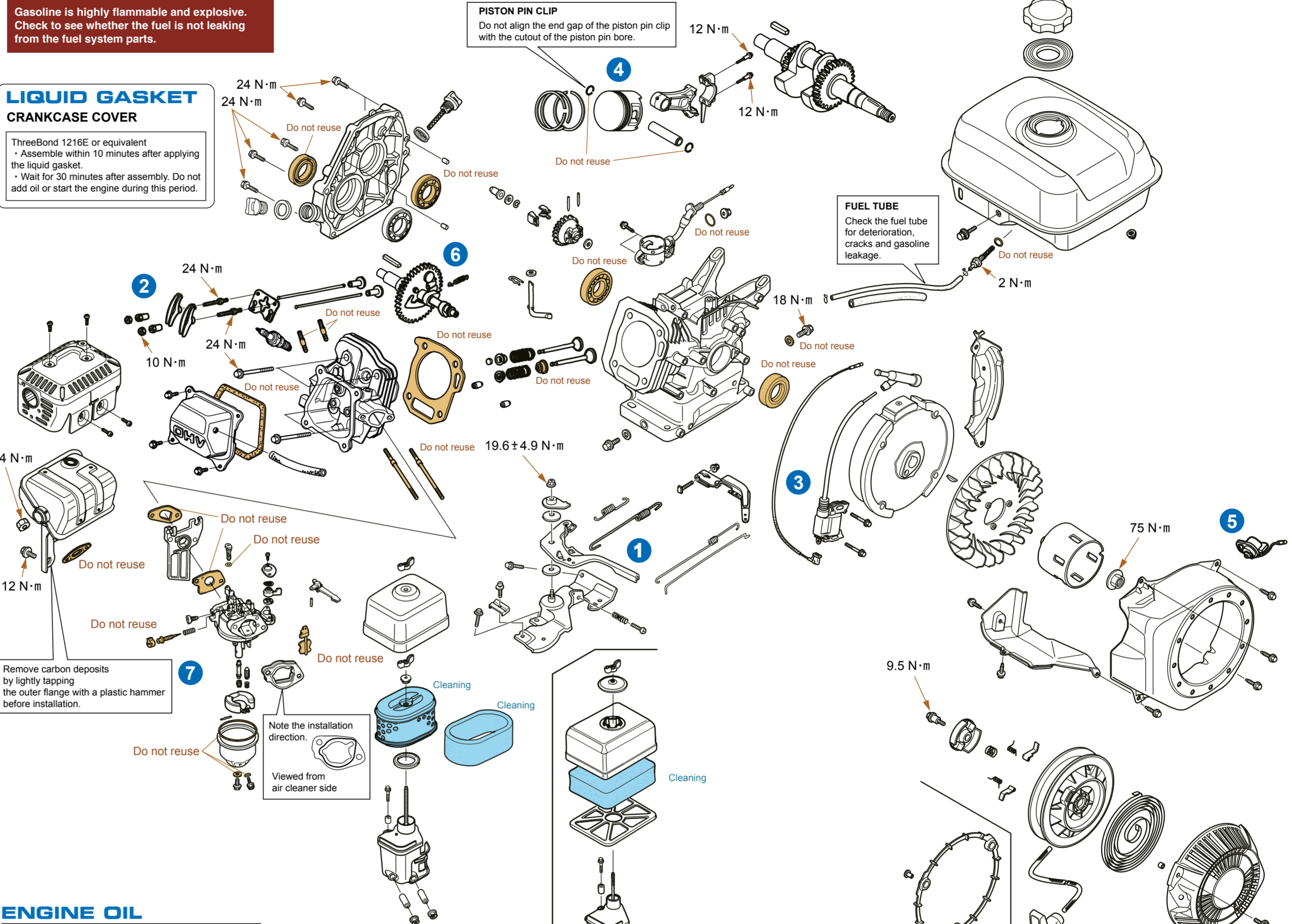

ENGINE OIL

Engine oil capacity	GP 160H	0.58 L (0.61 US qt)
	GP 200H	0.60 L (0.63 US qt)

Recommended oil	SAE 10W-30 API Service Classification: SE or higher	
	ON	No
OFF	Yes	

SPARK PLUG

Spark plug gap	0.7 - 0.8 mm (0.028 - 0.031 in)	
Recommended Spark plug	NGK	BPR6ES
	DENSO	W20EPR-U

ENGINE STOP SWITCH

INSPECTION

Remove the engine stop switch connector. Check the continuity between the terminals at each switch position.

Switch position	Continuity
ON	No
OFF	Yes

If the correct continuity is not obtained, replace the engine stop switch.

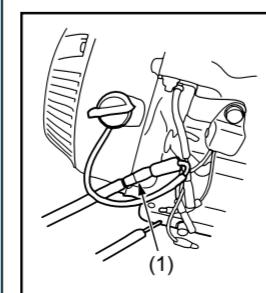

CAM SHAFT ASSEMBLY

Install the timing gear (1) of the crankshaft and camshaft (2) by aligning the punch marks (3).

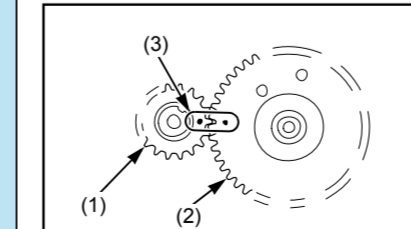

CARBURETOR

IDLE SPEED ADJUSTMENT

Start the engine and allow it warm up to normal operating temperature. With the engine idling, turn the throttle stop screw in or out to obtain the specified idle speed.

Specified idle speed	1,400 ± 200 min ⁻¹ (rpm)
----------------------	-------------------------------------

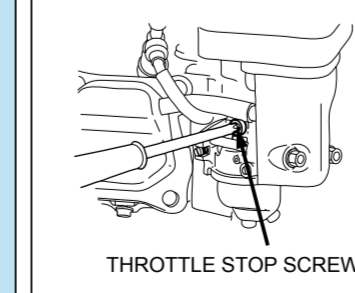

REMOVAL INSTALLATION

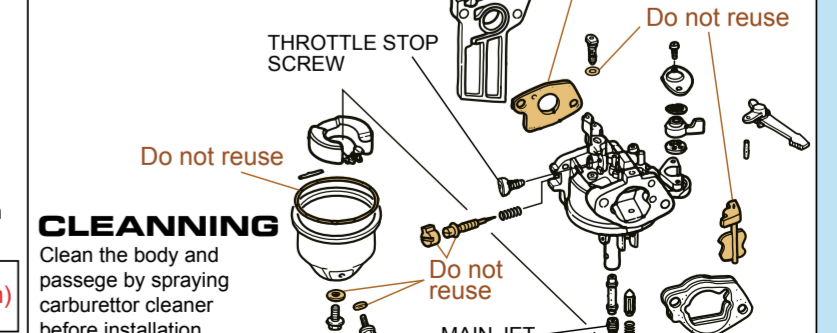

© Honda Motor Co., Ltd. Power Product Service Division.