

## GOVERNOR

### ADJUSTMENT

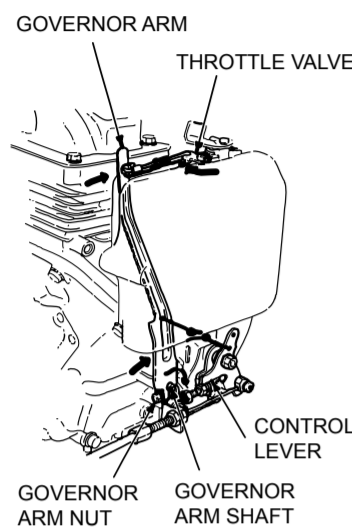

- 1) Move the control lever to the "FAST" position.
- 2) Loosen the governor arm nut on the governor arm.
- 3) Push the governor arm end toward the carburetor side, and open the carburetor throttle valve fully.
- 4) Holding the carburetor throttle valve fully open, turn the governor arm shaft clockwise fully, and tighten the governor arm nut.
- 5) Check to see whether the governor arm and the carburetor throttle valve operate smoothly.
- 6) Start the engine and allow it to warm up to the normal operating temperature. Move the control lever to the maximum engine speed position and check the maximum engine speed.
- 7) Adjust the maximum engine speed, if necessary, by loosening the lock nut and turning the adjusting bolt in or out.
- 8) After adjustment, tighten the lock nut securely.

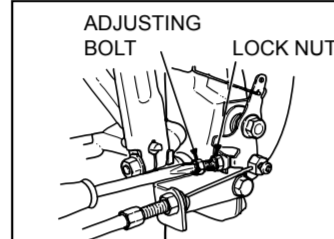

Maximum engine speed (no load)  
**4,100 ± 100 min<sup>-1</sup> (rpm)**

## VALVE CLEARANCE

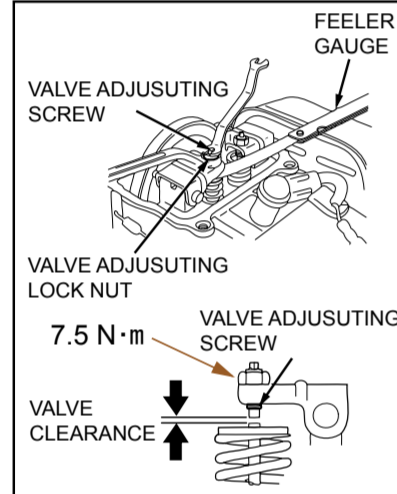

Valve clearance inspection and adjustment must be performed with the engine cold.  
 Top dead center of the compression stroke is the point where the cutout in the starter pulley (i.e. opposite side from the mark on the flywheel) is in alignment with the lower bolt hole of the fan cover.

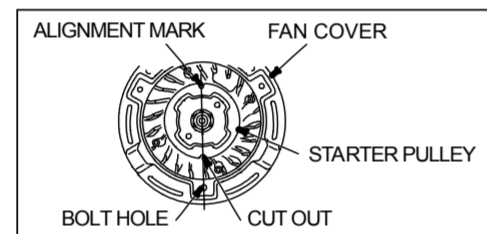

Insert a feeler gauge between the valve adjusting screw and the valve to measure valve clearance.

VALVE CLEARANCE **0.15 ± 0.04 mm (IN) 0.20 ± 0.04 mm (EX)**

## IGNITION COIL

### IGNITION COIL AIR GAP

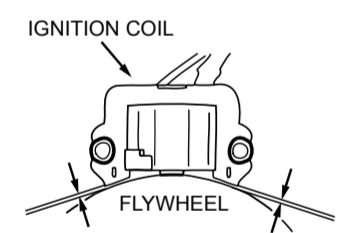

**0.2-0.5 mm 0.2-0.5 mm**

### INSPECTION

#### PRIMARY SIDE

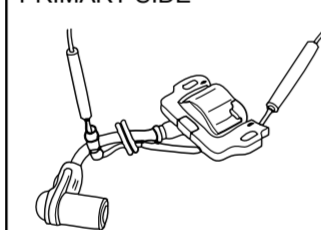

Primary side resistance value  
**0.75-0.95 Ω**

#### SECONDARY SIDE

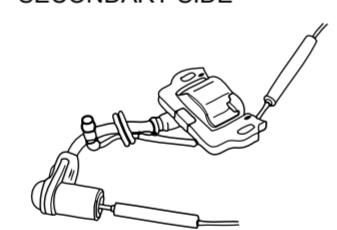

Secondary side resistance value  
**6.1-9.3 kΩ**

## PISTON DISASSEMBLY/REASSEMBLY

Install all rings with the markings facing up. Space the piston ring end gaps 120° apart.

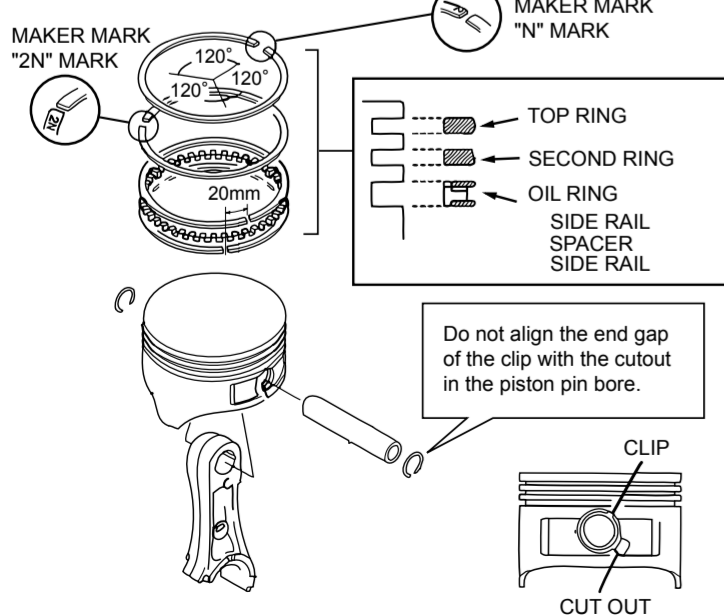

Do not align the end gap of the clip with the cutout in the piston pin bore.

## CAM PULLEY INSTALLATION

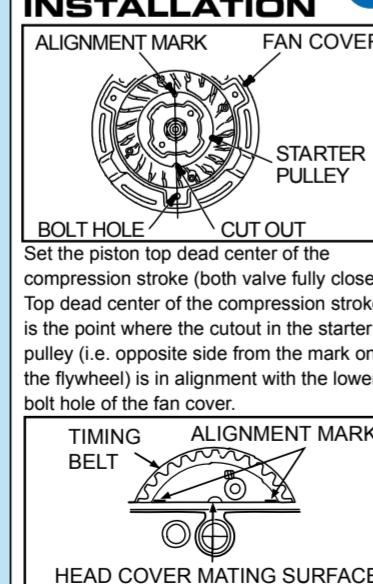

Align the alignment marks on the cam pulley so that they are in line with the head cover mating surface. Be careful to avoid turning the crankshaft when installing.

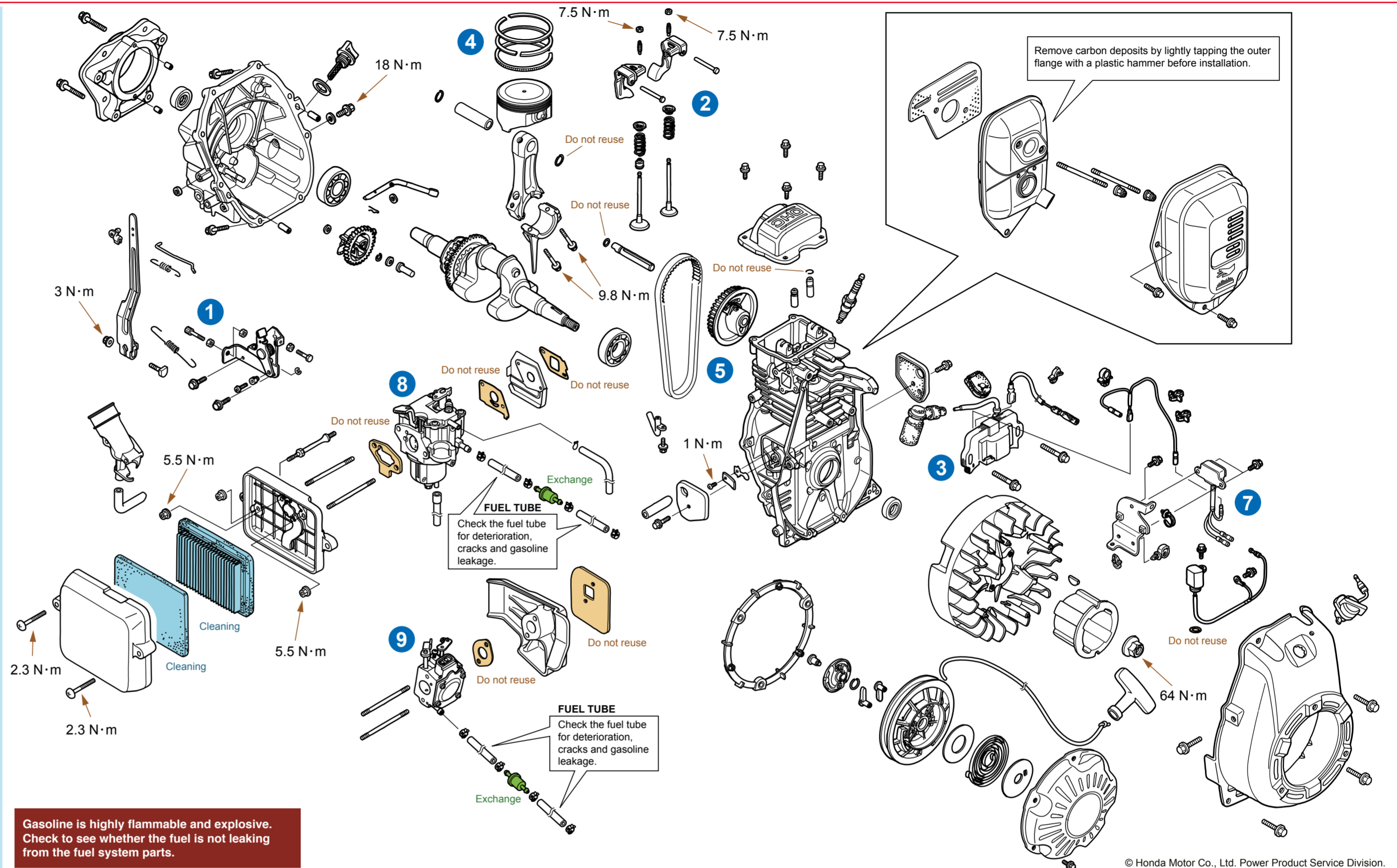

Gasoline is highly flammable and explosive. Check to see whether the fuel is not leaking from the fuel system parts.

© Honda Motor Co., Ltd. Power Product Service Division.

## ENGINE STOP SWITCH

### INSPECTION

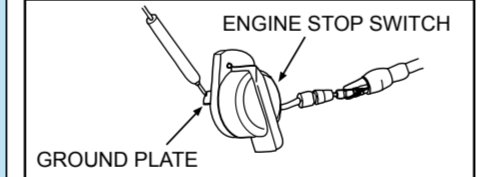

Attach the tester leads to the black wire and the ground plate of the engine stop switch, and check for continuity.

Switch OFF position : There should be continuity.  
 Switch ON position : There should be no continuity.

## IDLE SPEED ADJUSTMENT

- Start the engine and allow it warm up to normal operating temperature.
- With the engine idling, turn the throttle stop screw in or out to obtain the standard idle speed.

### FLOAT TYPE THROTTLE STOP SCREW

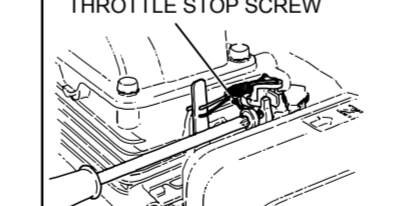

### FLOATLESS TYPE THROTTLE STOP SCREW

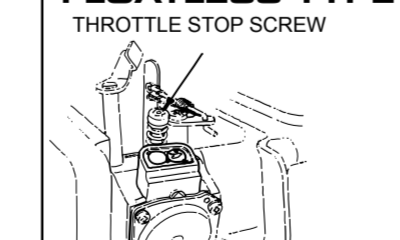

Standard idle speed  
**1,850 ± 150 min<sup>-1</sup> (rpm)**

## OIL ALERT INSPECTION

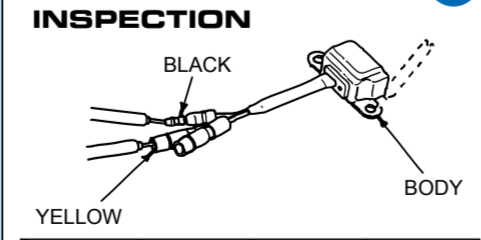

	BLACK	YELLOW	BODY
BLACK	∞	0.5-10kΩ	∞
YELLOW	0.5-10kΩ	∞	∞
BODY	∞	∞	∞

## CARBURETOR

### REMOVAL INSTALLATION

#### FLOAT TYPE

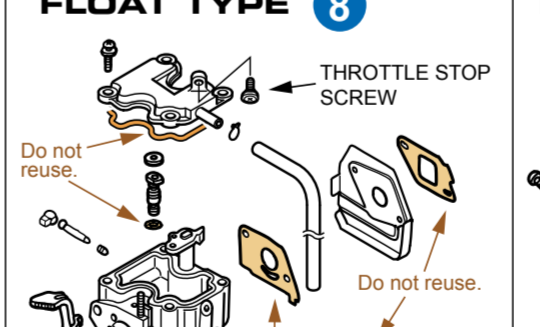

#### FLOATLESS TYPE

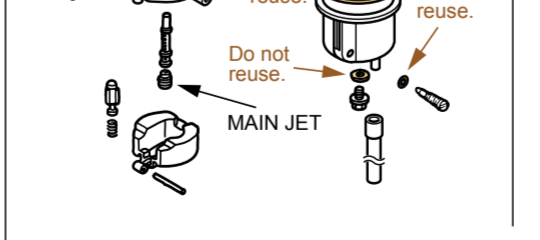

**CLEANING** Clean the body and passage by spraying carburetor cleaner before installation.

## SPARK PLUG

Spark plug gap	0.6 - 0.7 mm	
Recommended Spark plug	NGK CR5HSB	DENSO U16FSR-UB

## ENGINE OIL

Engine oil capacity	0.28 L (0.3 mUS qt, 0.25 Imp qt)	
Recommended oil	SAE 10W-30 API Service Classification SE or higher	

## LIQUID GASKET

**HEAD COVER CYLINDER BARREL**  
**ThreeBond 1207B or equivalent**  
 • Assemble within 10 minutes after applying the liquid gasket.  
 • Wait for 20 minutes after assembly. Do not add oil or start the engine during this period.