

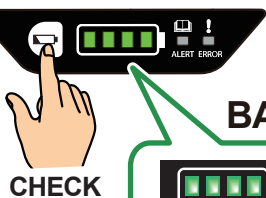

BATTERY PACK

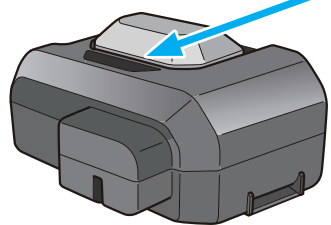

BATTERY CHARGE LEVEL

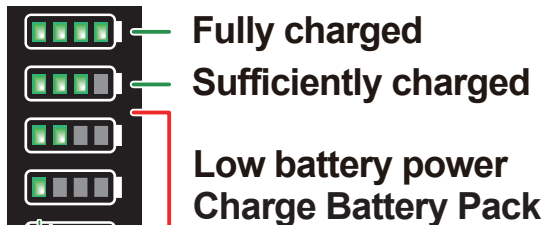

* Read and understand the Owner's Manual before operating the DC Power Unit.

Pre-operation check!

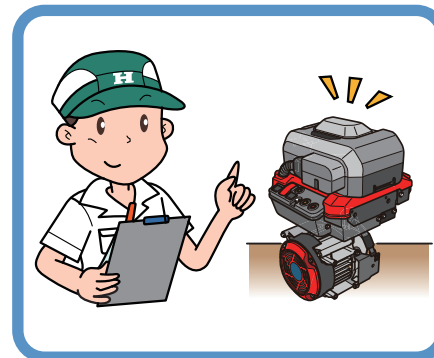

Safety Precaution

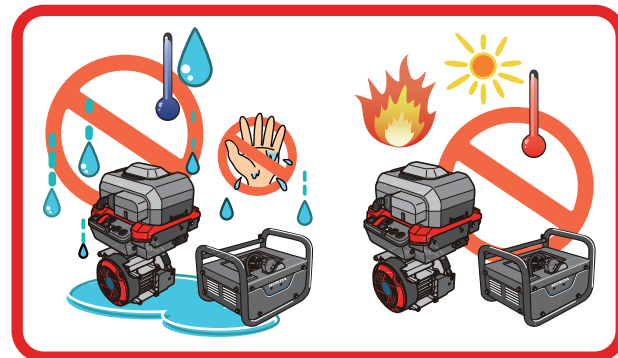

BATTERY CHARGER

Charging temperature range **5 to 30 °C**

Charge

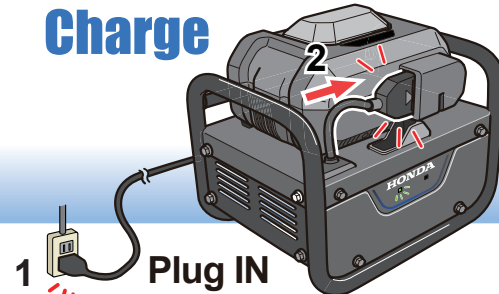
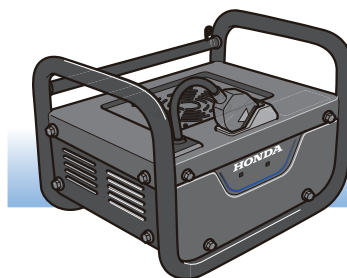

Attach Battery Pack

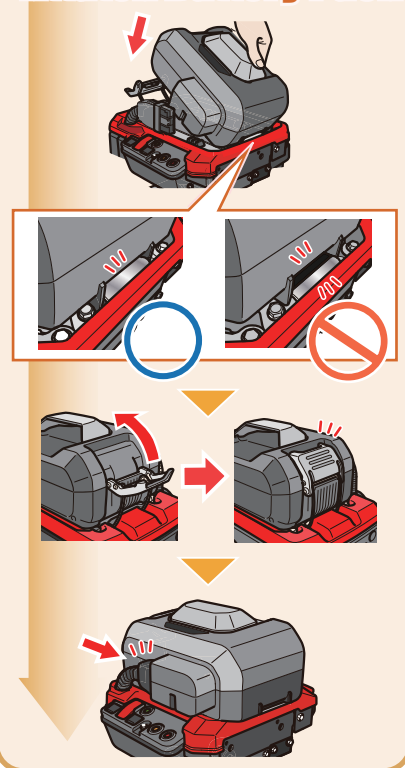

MOTOR UNIT

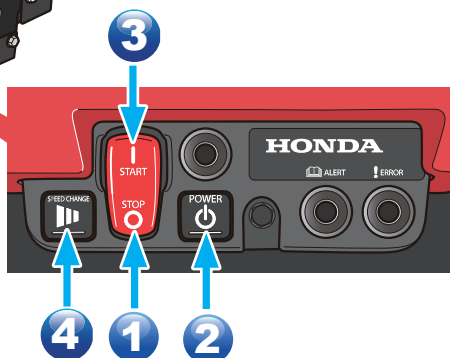

How to start

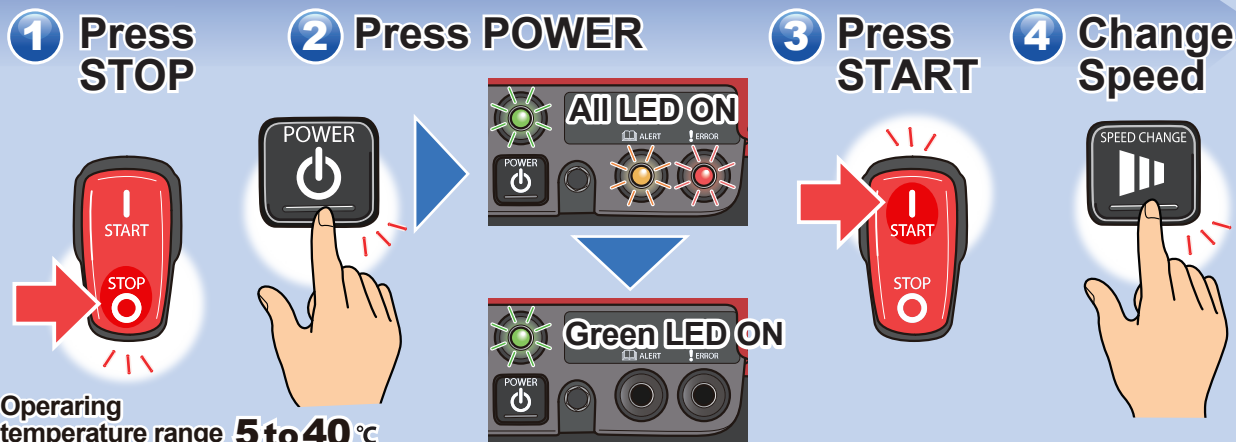

How to stop

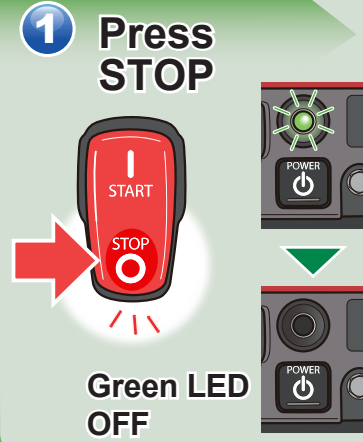



Maintenance Schedule

👁️ : Check 🔄 : Change 🧽 : Clean

Regular Service Period	Each use	Every 5 years or 500 hrs.
Exterior	👁️	👁️ Check not damaged
1 Switch	👁️	
2 LED	👁️	
3 Power cable	👁️	👁️ Check not damaged
4 Wire harness	👁️	👁️ Check not damaged
5 Battery fastener	👁️	👁️ Check not damaged
6 Rubber support	👁️	👁️ Check not damaged
7 Battery hook	👁️	👁️ Check not damaged

1 Switch

Check switches work properly(start and stop)

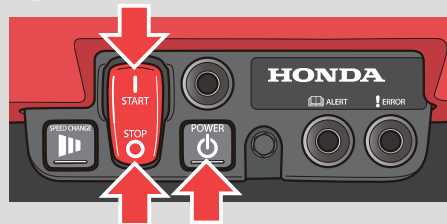

2 LED

Check all LED light ON when POWER is turned on

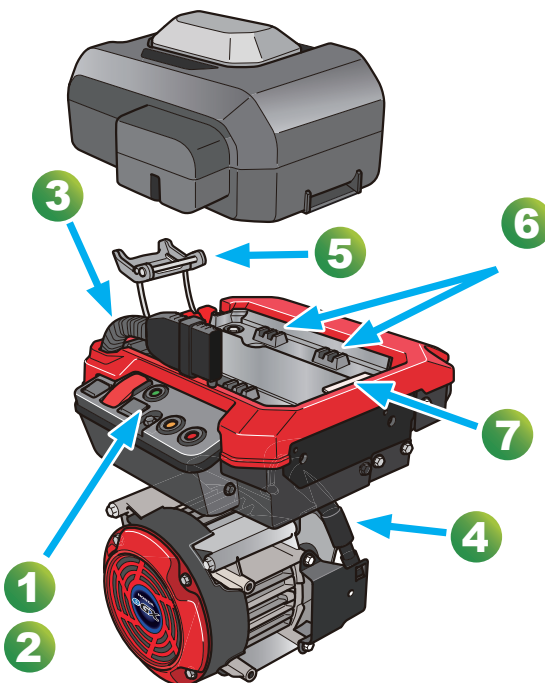
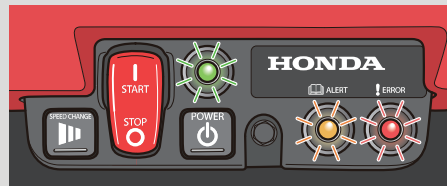

Wire harness



Battery fastener



Rubber support



Battery hook



Drain hole



Set speed

Rated speed

Medium speed

Low speed



When required
If an usual sound is heard

Take the DC Power Unit to your Honda servicing dealer.

* Read and understand the Owner's Manual before operating the DC Power Unit.

Storage

Storage temperature range **-5 to 30°C**



Long-term storage is not possible

➔ Use Battery Pack to discharge

Long-term storage is possible



Long-term storage is not possible

➔ Charge Battery Pack

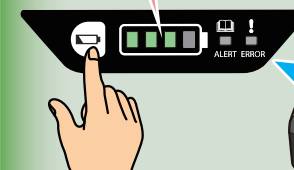

CHECK

Remove the Battery Pack

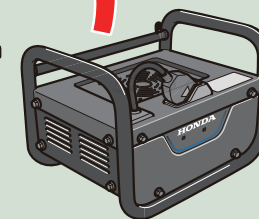
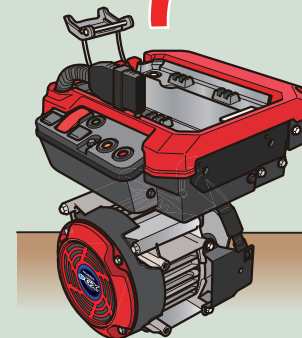

Unplugged

